

Welcome! As you enter the room, please...

- ❑ Plug in your headset (if available).
- ❑ Enable your speakers and mic (the icons on the top bar should be green).
- ❑ Run the audio setup wizard (see the “Meeting” menu on the left of the screen).
- ❑ “Raise your hand” by clicking the icon to let the hosts know you are ready to test your mic.
- ❑ After testing your mic, mute yourself by clicking the mic icon (to avoid background noise).

Feel free to use the chat at any time!

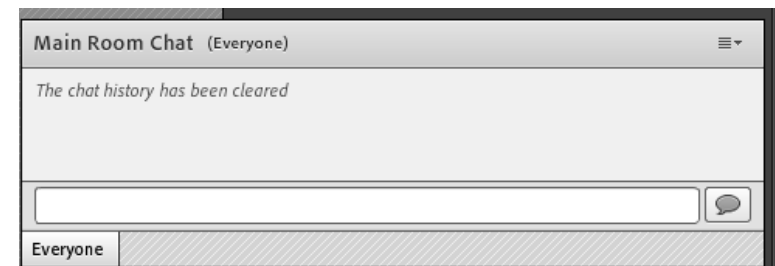

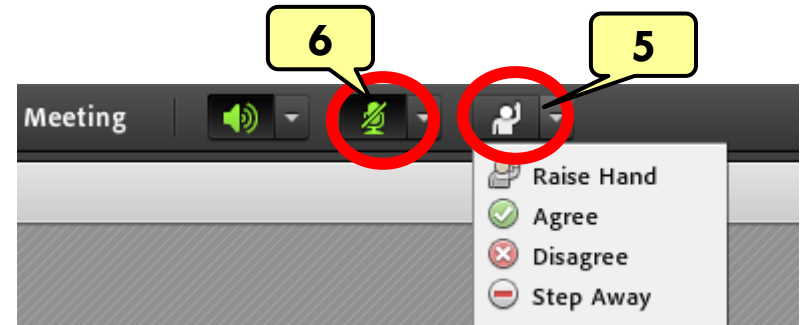
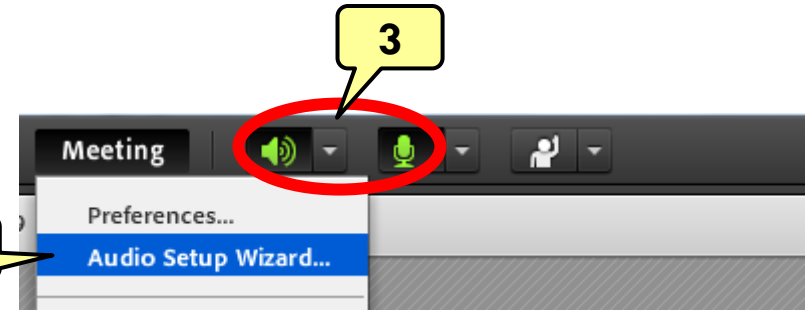

Start Recording!

ECE Virtual Community of Practice



Session 4

Promoting Teamwork

November 19, 2013

Tentative Agenda

- Logging in, welcome, session goals (10 minutes)
- Brief Review of Effective Teams (5 min)
- Responding to the homework (30 minutes)
 - ▣ Breakout (#1) with report outs
- Effective teamwork assignments (30 minutes)
 - ▣ Individual reflection and writing
 - ▣ Breakout (#2) with report outs
- Plans for Session 5 (15 minutes)

Rules of Engagement

Create your own bubble of solitude:

- ❑ Close your office door
- ❑ Use a “Do Not Disturb” sign
- ❑ Turn off e-mail
- ❑ Silence or forward phone
- ❑ Avoid any other potential distractions

ECE VCP Session 4 Goals

- Continue building our Community of Practice (CP)
 - ▣ As a whole (ECE VCP)
 - ▣ Within each of the 4 working groups
- Discuss teamwork readings, including
 - ▣ Most useful insights
 - ▣ Unanswered questions
- Describe successes and challenges in using teams in teaching engineering and in your classes in particular
- Reflect on how to use teams effectively

Readings for Session 4: Promoting Teamwork

- ▣ Review the following website about building teams
 - www.catme.org
- ▣ Watch the following two videos
 - <http://web.mit.edu/edtech/casestudies/teal.html#video>
 - http://youtu.be/IfT_hoiuY8w
- ▣ Read (posted on portal) and be prepared to discuss
 - C. Finelli et al., Student Teams in the Engineering Classroom and Beyond: Setting up Students for Success, Center for Research on Learning and Teaching, University of Michigan, 2011.

Poll: Homework Readings

- Which of the four resources were most useful to you?
(You may vote for more than one!)

Homework for Session 4: Promoting Teamwork

- Post a file to the portal answering the following questions (number them, please!):
 1. one insight from the reading
 2. one question you have from the reading
 3. Do you already use teams in class? If so, what is one thing you do with teams? Did the readings give you any new ideas?
 4. In your view, what is the biggest challenge to incorporating teams in engineering classes?
 - A. For students?
 - B. For faculty?

Post your homework to the portal!

5 traits of effective teams

- Positive Interdependence
- Individual Accountability
- Face-to-face Interaction
- Interpersonal and small-group skills
- Assess team performance

4 Components of using Student Teams Effectively



1. Design good team assignments
2. Construct teams carefully
3. Teach teamwork skills
4. Assess student teams

ECE VCP Working Groups

□ Group 1

- Nuri Emanetoglu, Electronics
- Puteri Megat Hamari, Electronics
- Nisha Kondrath, Electronics
- Harry Powell, Electronics

□ Group 2

- Shiny Abraham, Circuits
- Liz Brauer, Circuits
- Alisa Gilmore, Controls
- Raghu Mudumbai, Circuits
- Aurenice Oliveira, Signals & Systems

□ Group 3

- Kennedy Aganah, Energy Conversion
- Tim Kane, E&M
- Nathalia Peixoto, Circuits
- Nur Sisworahardjo, Circuits
- Sandra Soto-Caban, Circuits/Electronics

□ Group 4

- Danai Chasaki, Computer
- Mary Knox, Signals & Systems
- Faramarz Mossayebi, DSP
- Matthew Watkins, Digital

Breakout Group Tasks: #1

- Roles for today: Person with last name
 - ▣ Last alphabetically is the **scribe** to record discussion on electronic notepad
 - ▣ First alphabetically is the **reporter** to share important points in report out

- In your group, discuss one or more of the following (**first** person alphabetically **leads discussion**):
 1. What unanswered questions do you have from the reading and watching for this week?
 2. How do you use teams in your classes now? Did the homework this week give you any new ideas?
 3. What are the biggest challenge to incorporating teams in engineering classes? How can we overcome them?

- Time allotted: 20 minutes with 10 min report out

Individual Writing (7 min)

- 4 components of using teams effectively
 - ▣ Design good team assignments
 - ▣ Construct teams carefully
 - ▣ Teach teamwork skills
 - ▣ Assess student teams

- For each of these 4 components, write about
 - ▣ (1) If/how you are addressing each component in a team assignment you already use (and how you can improve).
 - ▣ (2) How you could address each component in the team assignment you'd like to develop

Breakout Group Tasks: #2

- Roles for today: Person with last name
 - ▣ Last alphabetically is the scribe to record discussion on electronic notepad
 - ▣ First alphabetically is the reporter to share important points in report out
- In your working group, discuss (start with scribe):
 - ▣ Successes and challenges of applying the 4 components of using teams effectively
- Time allotted: 15 mins in groups, 8 mins for report out

Plan for Session 5: Focus on Deliverables!

- At the end of the eight-week session, each participant will deliver a memo describing the new technique they plan to incorporate in their class.
- The memo will address the following elements:
 - What will you do?
 - What will your students do?
 - What will your students learn?
 - Why did you choose this technique?
 - What challenges do you anticipate?
- During next week's session, each participant will give a short presentation describing their plan for incorporating the new technique.

Assignments for Session 5

- ▣ Part 1: Start developing your deliverable
 - Draft the memo described on the previous slide. Answer the questions as best you can at this point. Identify questions you need to consider or further information you need before implementing the technique in the spring. **Post your draft to the portal.**
 - Prepare a 3-minute (informal) presentation describing the technique you've chosen and your plan for implementing it. Make one slide to support your presentation, and email it to Jill (jnelson@gmu.edu) **as a PDF** by 12 pm EST Monday (11/25).
- ▣ Part 2: Mid-term evaluation
 - Please complete the mid-term survey available at: <https://www.surveymonkey.com/s/H9GTPVR>
- ▣ Deadline for all homework: 12 pm EST Monday (11/25).